

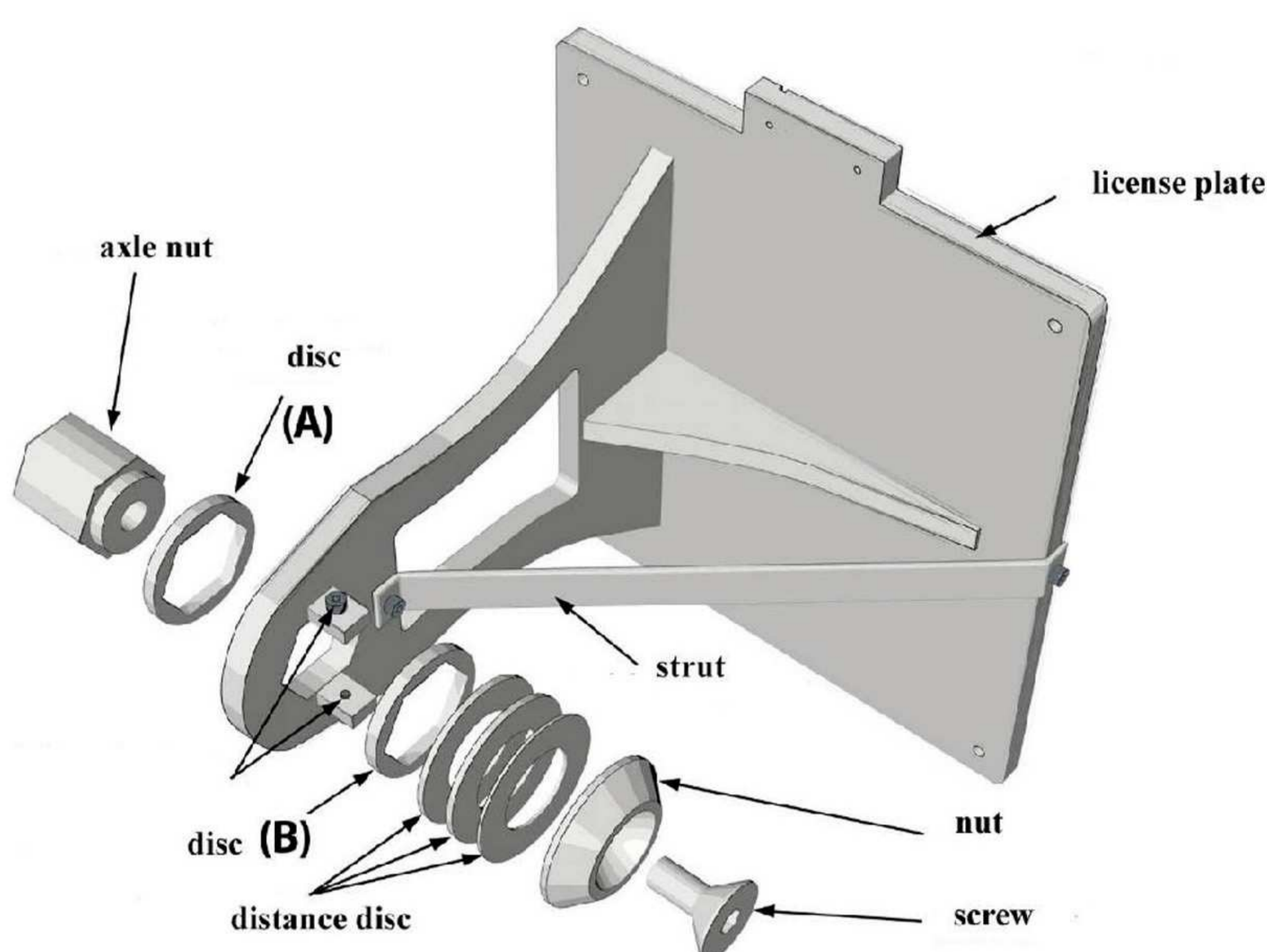

Mounting instructions for license plate holder Harley Davidson Softail- & Dyna-Modelle

Our side license plate holder is made of high quality aluminum and is characterized by its stability, ease of mounting and its adjustability. Please note that some Harley models have the axle nut RIGHT, so the axle is inserted from the left. If this is the case you have to pull out the axle, turn it over and insert it again on the right. In addition it may be that you have to remove the rear silencer in order to be able to reinsert the axle into the rocker and the wheel. The operations are described in detail below again.

Please secure all screw connections with a screw locking device, e.g. Loctite.



Top :

Here are all important components of the license plate holder shown and named.

The three different spacers allow a distance compensation, if you still want to attach a pannier holder or the like to the axle.

There are also two washers with a hexagon cutout. The disc (A) only has to be installed if your axle has a recess (as on our machine here in the assembly instructions) and the license plate holder does not lie flat on the rocker arm. The washer (A) equalized the gap on the rear axle. The washer (B) must be installed, this is required to secure the license plate holder.

Preparatory work:

1a) For the axle nut fitted in the factory on the right:

If the exhaust system should interfere with disassembly or assembly of the axle, it must be dismantled. The motorcycle has to be jacked up. For this purpose, you best use a pair of scissors motorcycle. The motorcycle should only be raised so far that the rear wheel is just relieved. The axis usually has a diameter of 1 inch, that is about 25 mm. A sawn-off broomstick 25 mm in diameter and about 40 cm in length is a great help in the following operations, as he holds the rear wheel in position while the axle is turned. To do this, push the axle with the light strokes of a rubber hammer to the axle nut support of the swingarm. Now put the broomstick at the end of the axle and drive it with light blows through the wheel hub. The axis is disengaged to the left. If the axle is completely free, you can

You attach them from the right and drive with her turn the broomstick until the axle sits on stop on the swingarm. Now the axle thread on your left, as it is necessary for the attachment of our license plate holder.

1b) For axle nut fitted at factory left: Loosen and remove the axle nut.

2) If your vehicle has a hollow axle, there may be a screw or plug in it to prevent dirt from entering the axle. This screw or plug must be removed for mounting the axle nut.

3) As soon as the free axle thread on the left looks out of the swingarm, you can start mounting our holder.

BUFFALO BAG

HANDCRAFTED LEATHER

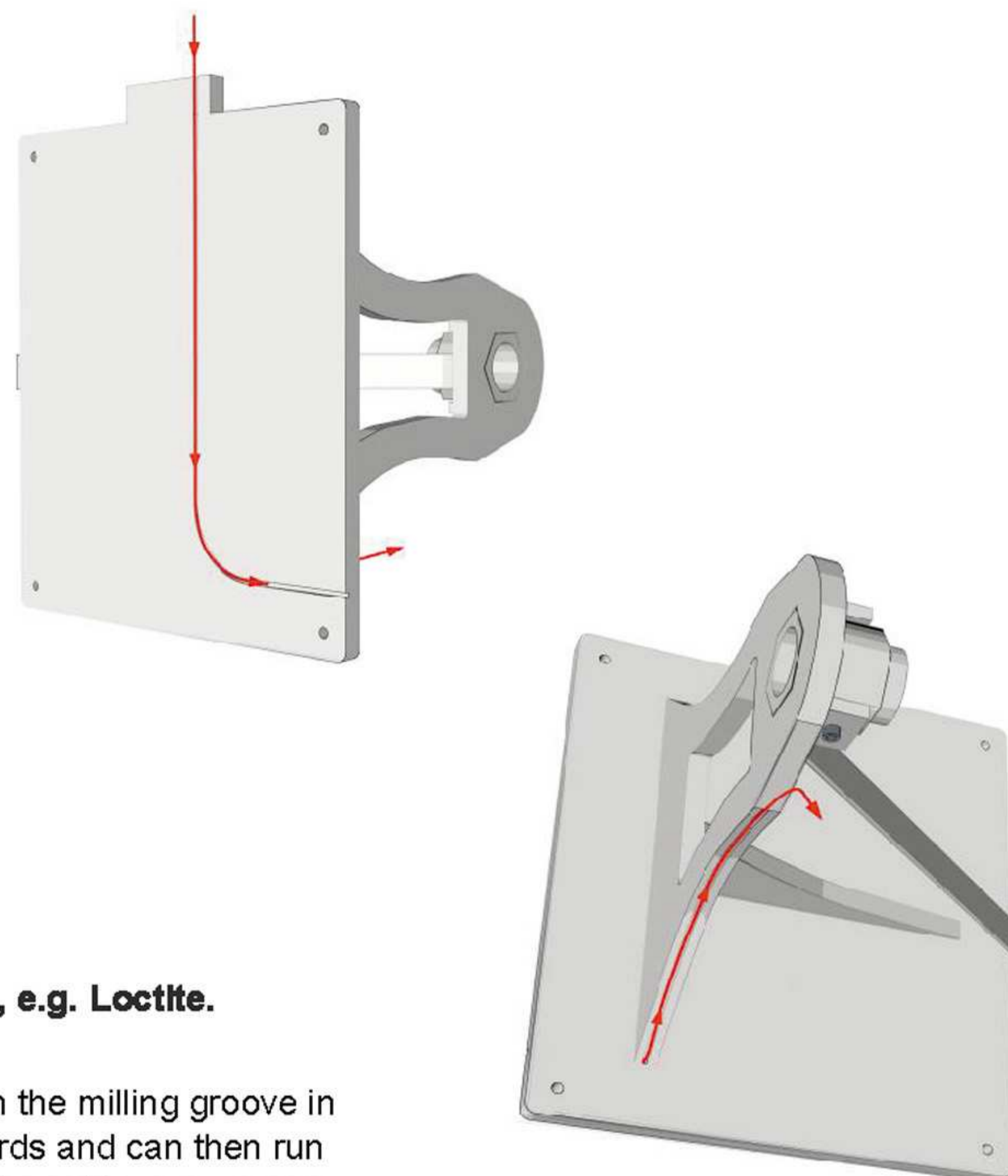
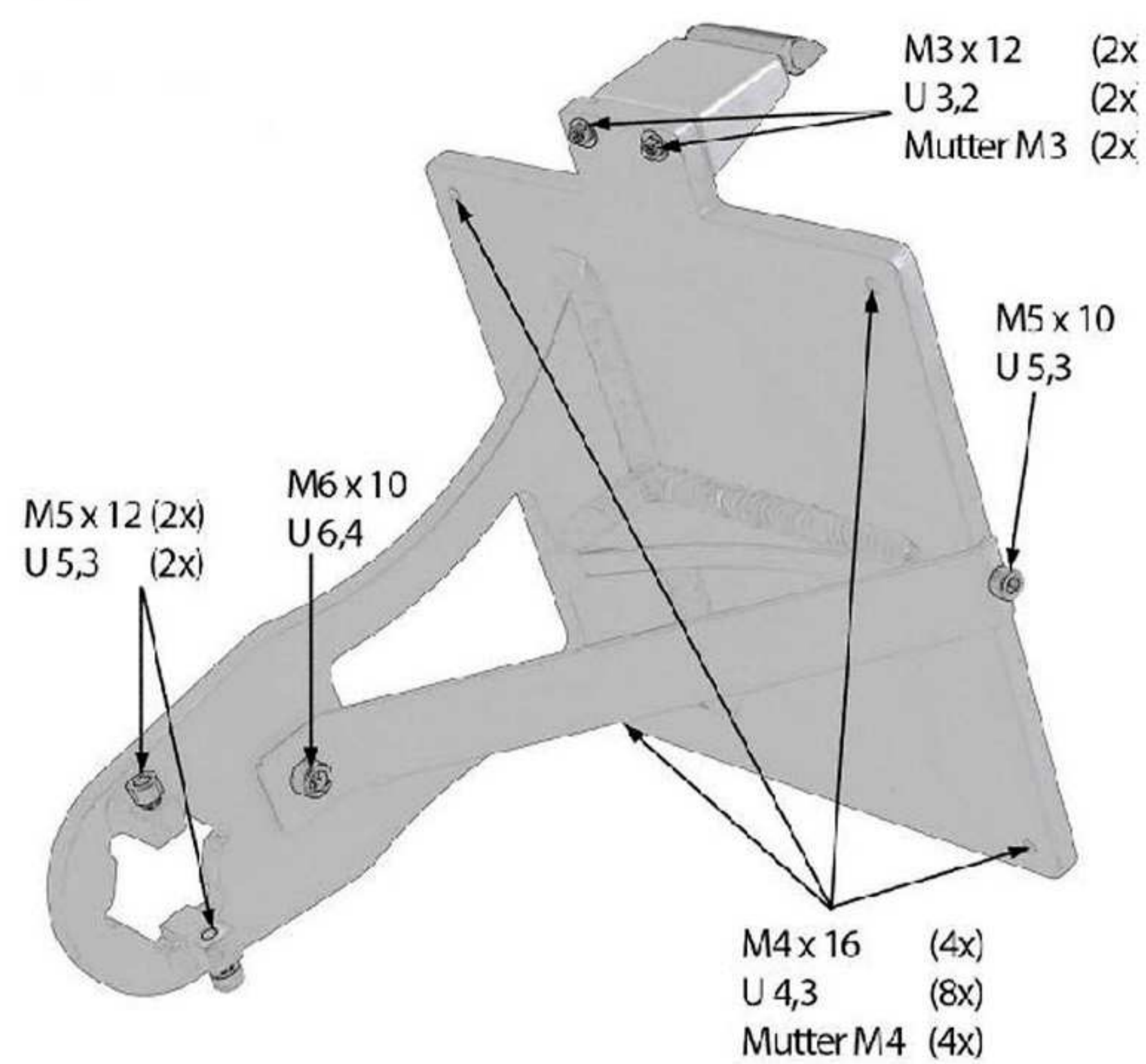
Please secure all screw connections with a screw locking device, e.g. Loctite.

Illustrations on the right: The license plate light cable is routed through the milling groove in the retaining plate, pushed through the small hole at the bottom forwards and can then run through the milling of the retaining strut. You will need to do this with the cable, e.g. secure with super glue or similar in the groove.

Professional assembly of our license plate holder:



Picture 1: Our axle nut is screwed onto the rear axle with the original washer.

Picture 2: Be sure to use a torque wrench to tighten the axle nut and to maintain the tightening torque specified by the motorcycle manufacturer. This is 81-88 Nm for Softail models and 128-142 Nm for Dyna and Sportster models.



Picture 3: Now slide the first washer with hexagon socket on the axle nut. It ensures a correct fit of the holder on the wheel axle.

BUFFALO BAG

HANDCRAFTED LEATHER



Bild 4

Picture 4: Now you can push the license plate holder onto the axle nut until it touches the swingarm. If you do not like the angle of the holder, you need to loosen the nut slightly, turn the axle accordingly and tighten the nut again properly.



Bild 5



Bild 6

Picture 5 & 6: Now that you have put the holder on the axle nut, it is imperative that you put the second hexagon socket washer on the nut from the front. As a result, the license plate holder is fixed and clamped.

Picture 7: Now you can put the appropriate number of spacers on the nut and tighten with the lens and the associated nut.



Bild 7

Picture 8: Finally fix the holder with the two hexagon socket screws. Important! **These serve only as additional fixation and may only be tightened to 3 Nm.**



Bild 8



License plate lighting must have a certain distance to the license plate area within the EU. That's why we have included a spacer that you should install (right). Outside the EU, this sheet can be omitted (left).

If you have not mounted a saddlebag, then you must now mount the stabilizer bar. To mount the license plate, first fix the license plate with some tape on the holder and mark the attachment points. Once the holes are in place, secure the license plate with the four M4 x 16 bolts and washers and nuts. Important!

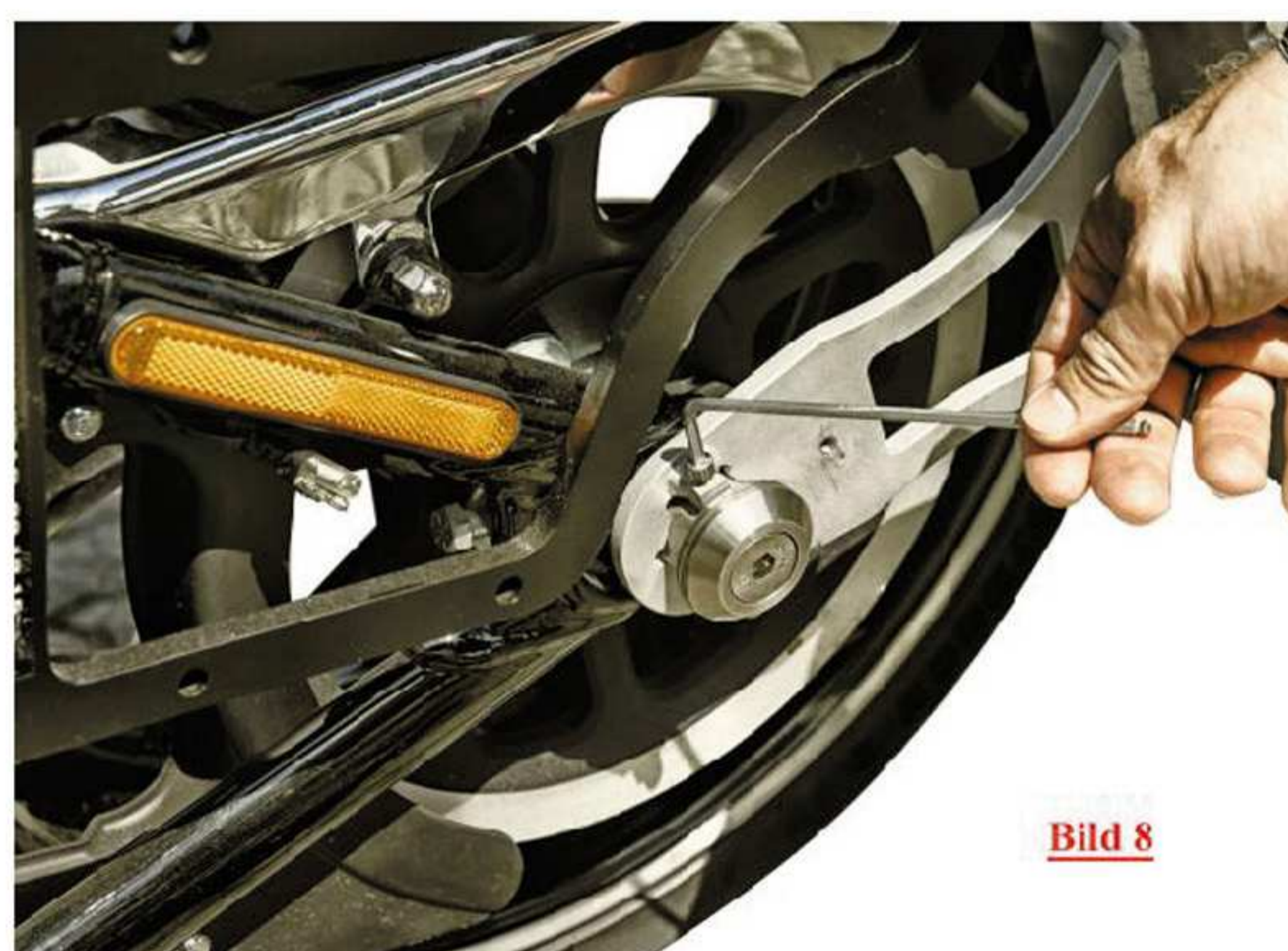
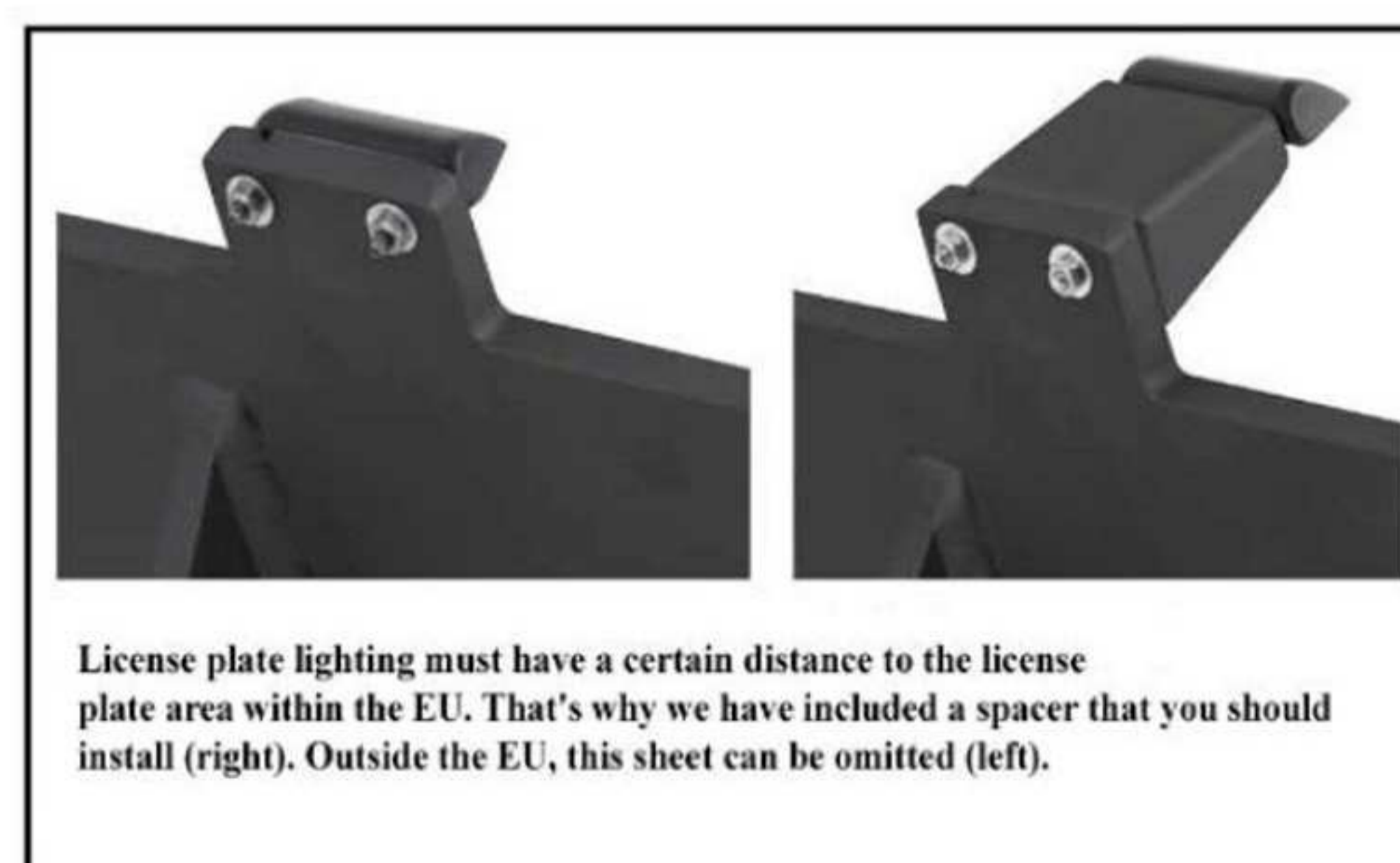
Please secure all screw connections with a screw locking device, e.g. Loctite.

BUFFALO BAG

HANDCRAFTED LEATHER



BUFFALO BAG
HANDCRAFTED LEATHER

DER KATALOG 2024/2025

Further information about our saddlebags and all accessories can be found at:

www.buffalo-bag.com



Hansen Styling Parts
Dorfstr. 9
24247 Mielkendorf

Tel.: 0049-4347-706970
Fax.: 0049-4347-3201
info@hansen-styling-parts.de
www.hansen-styling-parts.de
www.buffalo-bag.com