

BUFFALO BAG

HANDCRAFTED LEATHER



Mounting instructions saddlebag 28 Liter – Harley Davidson Sportster

Scope of supply:

- 1x Saddlebag 28 liter black
- 1x bracket
- 1x Bushing black M8 x 16
- 1x Allen screw M8x80
- 2x Allen screw M8x20
- 1x Washer spring M8
- 6x Washer 8,4
- 3x Nut M8 self-locking
- 1x Nut M8

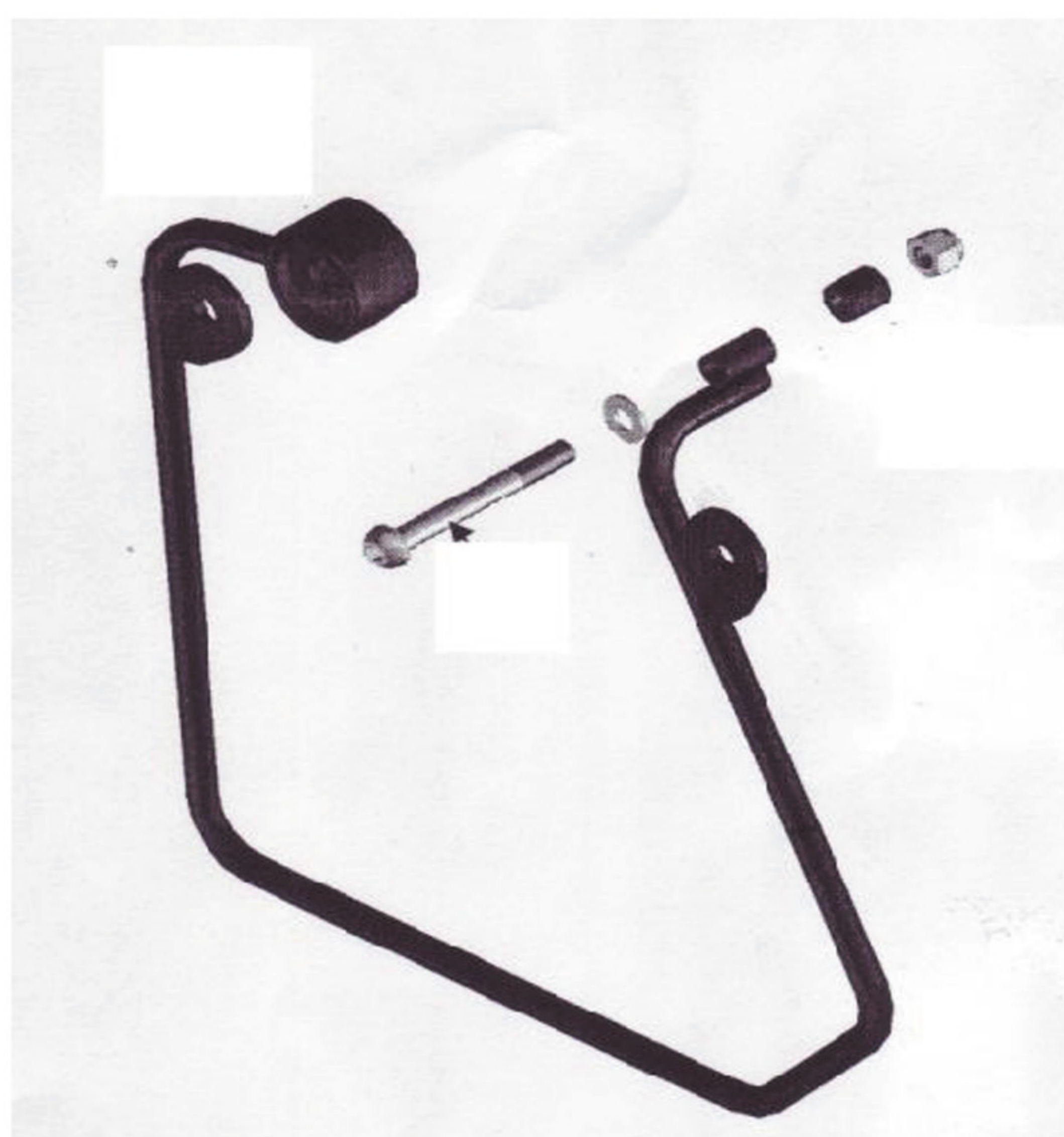

The saddlebag bracket is mounted with 2 screws. The front bolting is done with the shock. For the rear mounting, the serial bolting with the fender struts has to be removed. For the mounting bushings and mounting material is included in the delivery.

After mounting the bracket, the position of the saddlebag has to be determined. Mark the drill-data with a pen on the backside of the bag, so that the bracket fits probably. Then drill 8mm holes through the aluminum plate sewed to backside of the saddlebag and screw the bag and bracket together.

